

Junction Box Bracket Attachment used with Pegasus Comp Conduit and Junction Box Attachment Kit

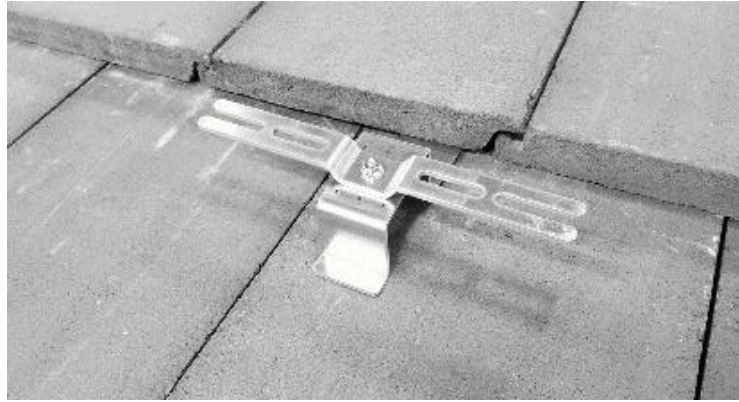

Junction Box mounted on a Tile Accessory Mount using the Pegasus Junction Box Bracket Attachment.

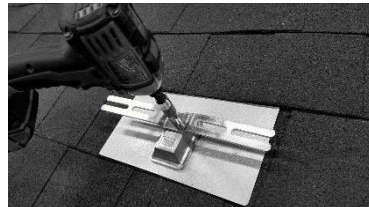

1. Comp: Install conduit mount per instructions. Thread lag through junction box bracket with EPDM washer on mount and drive lag.

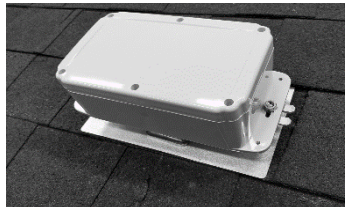

2. Comp: Use enclosure hardware to attach flange to bracket and tighten.



1. Tile: Install Tile Accessory mount per instructions. Use the included hardware to attach the junction box bracket to the Tile Accessory Mount.



2. Tile: Use enclosure hardware to attach flange to bracket and tighten.

The Pegasus Solar Junction Box Bracket Attachment is an ideal solution for flange-mounted enclosures on either a tile or comp shingle roof.

- For use with flanged enclosures
- Recommended for enclosures 10" or less in width
- Comp Shingle: compatible with Pegasus Comp Conduit and Junction Box Attachment Kit (PSCA-AM)
- Tile: compatible with Pegasus Tile Accessory Mount (PSTA-AM)
- Bracket allows for hardware to be pre-installed on enclosure with open channel
- Aluminum Mill Finish
- Comes in Boxes of 12

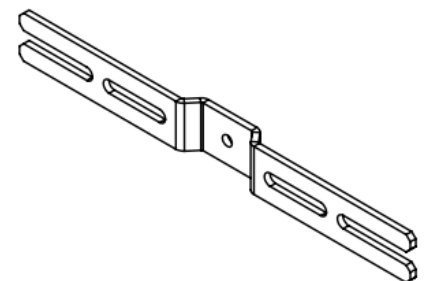
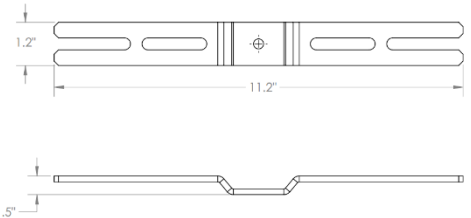

Specifications	Junction Box Bracket Attachment
Enclosure Requirements	Up to 10" wide with flange
Install Application	Junction Box Mount
Material	Aluminum
Compatible With (Tile)	PSCA-AM
Compatible With (Comp)	PSTA-AM
Box Quantity	12
Boxes Per Pallet	800
SKU	PSUA-JM

Patents Pending. All rights reserved.
© 2018 Pegasus Solar Inc.

